

Instructions by Time4Sleep Products

New England Solo Wooden Ottoman Storage Bed

Assembly instructions for New England Solo Wooden Ottoman Storage Bed by Time4Sleep.



Product Information

New England Solo Wooden Ottoman Storage Bed

Description

New and exclusive to Time 4 Sleep the New England Ottoman delivers timeless looks along side the practicality of having storage. The sprung slatted sleeping platform can be easily raised, with the assistance of the gas lift mechanism, to reveal a large capacity boarded storage area that is perfect for storing occasional items. This can be assembled to open from the left or right hand side to suit your needs.

This classical, elegant design will work well in any design scheme and would be perfect for main bedrooms, guest rooms and teenage bedrooms alike.

Simply one of the best value wooden storage beds available on the market today!

Internal storage height 27cm

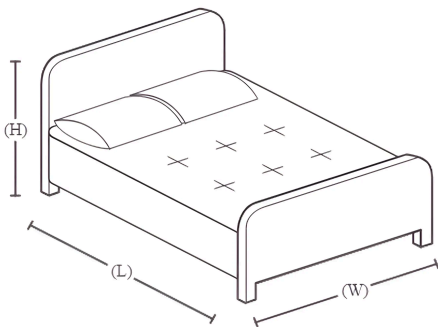

Product specifications

Single	
Width	105 cm



Length	213 cm
Head End Height	106 cm
Foot End Height	43 cm

#### SKU

newengott30whiteN, newengott30Oak

### Before you start

- Please read this sheet prior to assembly to familiarise yourself with the various stages of construction. Carefully open the pack supplied and check the contents against the parts and fittings check list.
- Do not destroy any of the packaging until you are certain that you have all the necessary parts for the assembly.
- Please ensure that the packaging is disposed of in a safe environmentally friendly way.
- **Caution:** There are small components used in the construction of this unit. These loose items should be kept away from young children during assembly, to avoid danger of choking.

### Care & Maintenance

In the unlikely event of missing or damaged parts, please contact your retailer. Please have this guide at hand quoting the part code reference numbers shown when requesting spare or replacement parts.

### General Hints & Tips

- Two person assembly
- Please retain your assembly instruction and tools provided for future use. Periodically check that all bolts are still tight.



## Warnings

- Before moving the slat frame, place the mattress on the slats. Without a mattress in place, the speed of movement is quick and may cause injury so great care is needed.
- Carefully lower the frame with the fabric hand-strap (10) ensuring the frame sides are aligned with the side panels; there should be an even gap on each side.
- If not aligned, check bed is still square and if it is, but gaps are still not even, re-align.
- Depending on the weight of the mattress, the rising speed will vary so be careful until you get used to the speed.
- Always use the hand-strap to lift or lower the frame - keep fingers well away from the moving parts.
- When fully assembled and the mattress in position, please raise & lower the ottoman 4/5 times to ensure the gas pistons are fully lubricated.
- You must ensure that the mattress is on the bed frame before operating the lift mechanism Failure to do so could result in injury.
- Keep hands clear of the mechanism when opening or closing the ottoman.
- Beware of entrapment – Never reach in through the mechanism to access the storage area.
- Always ensure that the ottoman is FULLY opened before accessing the storage area.

## Important when operating



- Use caution when operating, always use the handle when lifting.
- This bed uses a pressurised mechanism.
- To be operated by adults only Please ensure that children and pets are kept away from the bed when operating the lift mechanism.
- Keep children and pets away from the storage area.
- Do not overload the internal storage base.
- Do not stand inside the internal storage area of the bed.
- Before removing the mattress secure the frame to ensure it does not open unexpectedly.
- Do not attempt to lie on the mattress when the ottoman is in the raised position.
- When lifting the ottoman remove all bedding except the fitted sheet.

## Weight limits:

- **Double:** Min weight: 20 kg / Max weight: 50 kg
- **King:** Min weight: 20 kg / Max weight: 50 kg



## Tools

A - Hydraulic Base Support (Right and Left)

2



C - JCBB M8 × 25mm

16



E - JCBB M8 x 20mm

6



G - JCBC M6 × 40mm

6



I - M8 Hex. Nut

6



K - JCBC M6 x 90mm

4



M - Wood Dowel M8 × 30mm

12



O - Connecting Bolt

8



Q - Nylon Socket

8



S - M5 Allen Key

1



B - Hydraulic Pump

2



D - JCBC M8 × 15mm

8



F - Base Handle

3



H - JCBB M8 x 45 mm

6



J - ML-CB (Metal Corner Support)

2



L - Barrel Nut M6 x 15mm

4



N - Wood Button 14.5mm

4



P - Minifix Housing (Long)

8



R - M4 Allen Key

1



Phillips Screwdriver (Not included)

1

## Parts

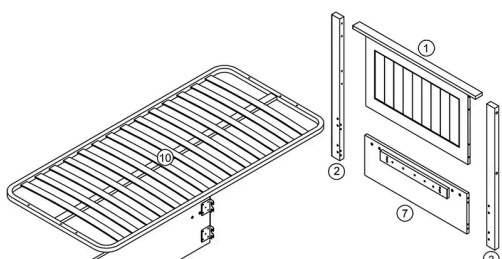

1

HB. Panel

1 piece(s)

2

HB. Post (Left)

1 piece(s)



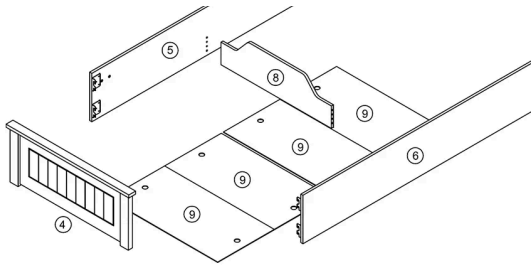

3 HB. Post (Right)  
1 piece(s)

4 FB. Panel  
1 piece(s)

5 Side Rail (Left)  
1 piece(s)

6 Side Rail (Right)  
1 piece(s)

7 HB. Bottom Panel  
1 piece(s)

8 Center Panel  
1 piece(s)

9 Bottom Panel  
3.8 piece(s)

10 Bed Slats  
1 piece(s)

## Steps (11)



## 1. Assemble the Headboard

1. Insert Wood Dowels (M) into the pre-drilled holes on both HB. Posts (Left & Right) (2, 3).
2. Insert Connecting Bolts (O) and the Nylon Socket (Q) through the pre-drilled holes on HB. Bottom Panel (7).
3. Align the HB. Panel (1) and the HB. Bottom Panel (7) between the HB. Posts (2, 3).
4. Secure HB. Panel (1) to HB. Posts (2, 3) using JCBC M6 × 90mm Bolts (K) and Barrel Nuts (L), tightening them with the Allen key.
5. Insert Minifix Housings (P) into the designated slots on the HB. Bottom Panel (7) and rotate them to lock the Connecting Bolts (O) in place.
6. Cover the bolt holes with Wood Buttons (N) for a clean finish.

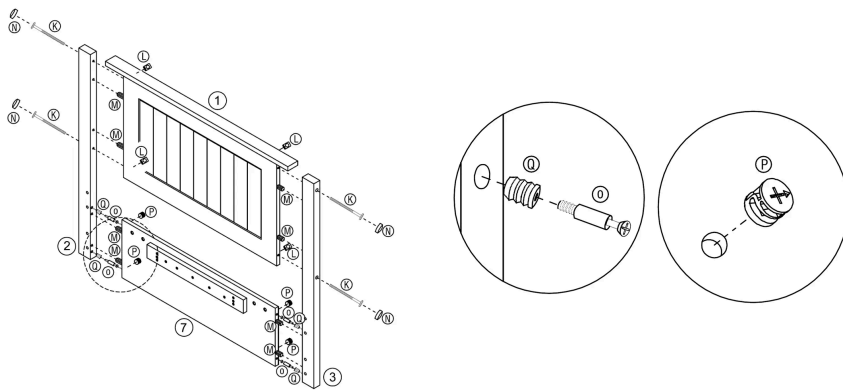

## 2. Attach the Center Panel to the Side Rails

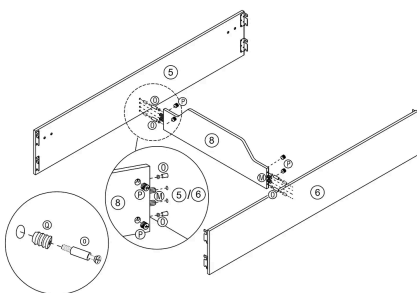

1. Insert Wood Dowels (J) into the pre-drilled holes on both ends of the Center Panel (8).
2. Insert Nylon Sockets (Q) and Connecting Bolts (O) through the designated holes on the Side Rails (5, 6).
3. Align the Center Panel (8) with the Side Rails (5, 6).
4. Insert Minifix Housings (P) into the designated slots on the Center Panel (8) and rotate them to lock the Connecting Bolts (M) in place.
5. Ensure all connections are tight and the Center Panel (8) is securely attached to both Side Rails (5, 6).



### 3. Attach the Side Rails, Footboard and Headboard

1. Align the Side Rails (5, 6) with the Headboard and Footboard.
2. Secure the Side Rails (5, 6) to the Headboard and Footboard using JCBB M8 × 25mm Bolts (C).
3. Ensure the brackets on the Side Rails (5, 6) fit properly into the designated slots.
4. Tighten all bolts to ensure the frame is stable.

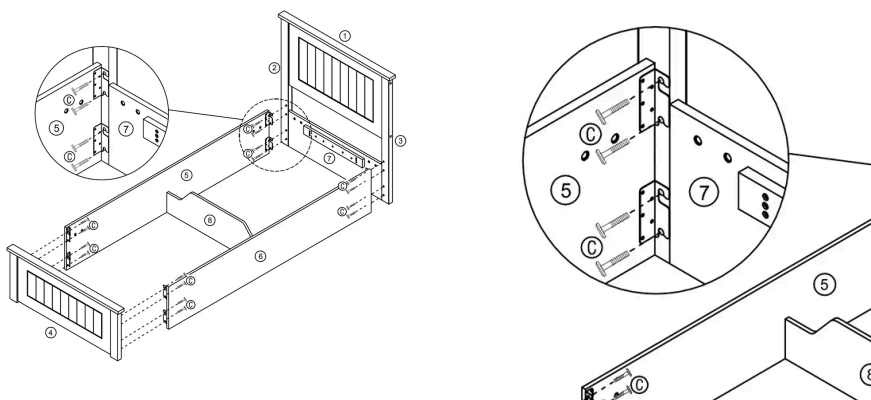

### 4. Install the Hydraulic Mechanism

1. Secure the Hydraulic Pump (B) to the Hydraulic Base Support (A) by aligning it properly.
2. Ensure the Hydraulic Pump (B) is installed in the correct orientation, as shown in the diagram.

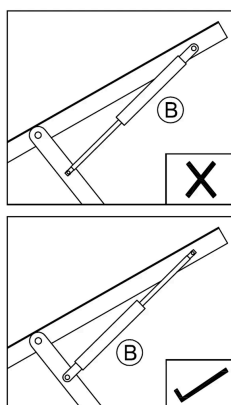
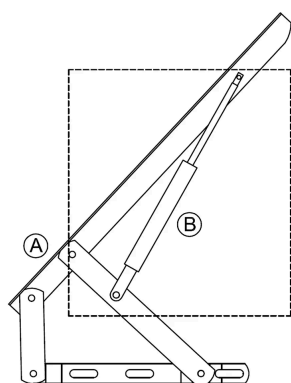

## 5. Secure the Hydraulic Mechanism to the Side Rails (Left Opening)

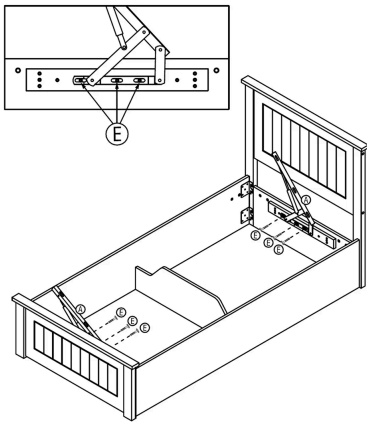

### Left Opening - Green Sticker

1. Align the Hydraulic Base Supports (A) with the pre-drilled holes on the Headboard and Footboard.
2. Secure the Hydraulic Base Supports (A) using JCBB M8 × 20mm Bolts (E).
3. Ensure the Hydraulic Mechanism is correctly positioned and securely fastened to the side rails.
4. Double-check that all bolts are tightened properly before proceeding.

## 6. Secure the Hydraulic Mechanism to the Side Rails (Right Opening)

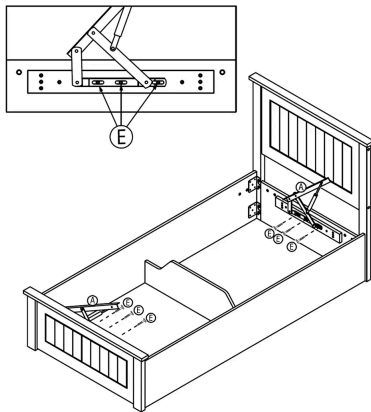

### Right Opening - Red Sticker

1. Align the Hydraulic Base Supports (A) with the pre-drilled holes on the Headboard and Footboard.
2. Secure the Hydraulic Base Supports (A) using JCBB M8 × 20mm Bolts (E).
3. Ensure the Hydraulic Mechanism is correctly positioned and securely fastened to the side rails.
4. Double-check that all bolts are tightened properly before proceeding.

## 7. Install the Bottom Panels

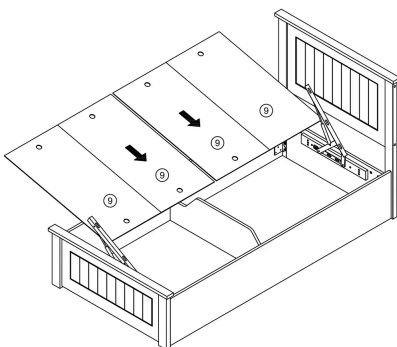

1. Position the Bottom Panels (9) over the storage area, ensuring they align with the frame.
2. Slide the panels inward following the direction of the arrows until they fit securely.
3. Ensure the panels are evenly placed and flush with the surrounding frame.





## 8. Attaching the Metal Corner Support

1. Align the Metal Corner Support (J) at the junction of the side rail and either the headboard or footboard, based on your chosen opening side.
2. Fasten the JCBC M8x15mm screws (D) using an Allen Key, ensuring they are tight.
3. Repeat the process on the opposite corner, ensuring the correct orientation for the storage opening.

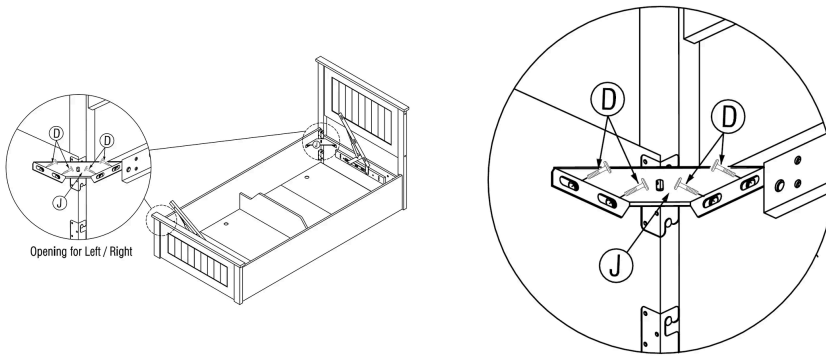

## 9. Attaching the Base Handle to the Slat Frame

1. Locate the pre-drilled holes on the slat frame for the base handle.
2. Position the base handle (F) over these holes.
3. Insert the JCBC M6x40mm bolts (G) through the handle into the holes and tighten them securely.
4. Ensure the handle is firmly attached and check for any movement.

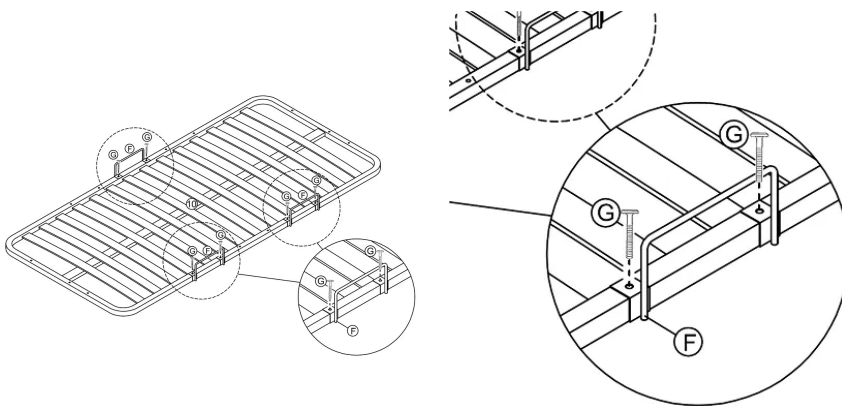

## 10. Secure the Bed Slats to the Hydraulic Base Support

1. Position the slat frame on the hydraulic base support.
2. Line up the pre-drilled holes in the frame with the mounting points on the hydraulic base.
3. Insert the JCBB M8x45mm screws (H) through the aligned holes.
4. Fasten each screw by threading the M8 Hex Nuts (I) onto the screws from the underside of the base.

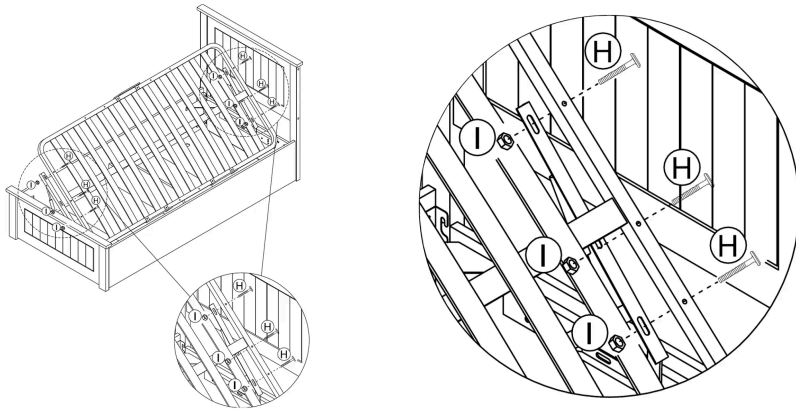

## 11. Final Check

- Verify that all slats are securely fastened and evenly spaced.
- Check for any loose connections and tighten the screws if necessary.

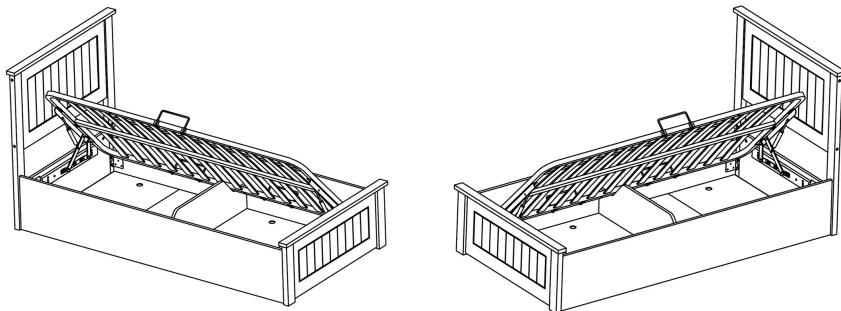

Need Help? Call 01484 500 560 or email [hello@time4sleep.co.uk](mailto:hello@time4sleep.co.uk) - please include your order number if you have one!

