

Instructions by Time4Sleep Products



Maya Winged Ottoman Bed

Assembly instructions for Maya Winged Ottoman Bed by Time4Sleep.

Product Information

Maya Winged Ottoman Natural - Bed Frame Only

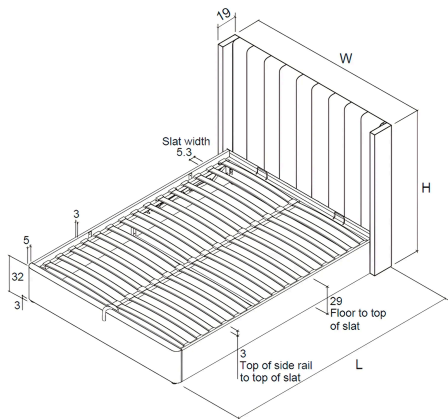

Description

Embrace tranquillity and functionality with the Maya Winged Ottoman Bed in Natural. This luxurious bed features a plush, upholstered headboard in a calming natural hue, accented with a stylish line design that adds a touch of modern flair to your bedroom. The winged sides provide a sense of enclosure and create a cosy sleeping haven. But the Maya's true magic lies beneath. Lift the ottoman base with its easy-access gas lift mechanism to reveal a generous 25cm deep storage compartment, ideal for stowing away bulky blankets, off-season clothes, or anything else you need to keep out of sight. With ample under-bed clearance of approximately 15cm, the Maya Winged Ottoman Bed in Natural is a dream come true for those seeking both a serene aesthetic and practical storage solutions.

Product specifications

	Double	King Size
Width	155 cm	170 cm
Length	206 cm	216 cm
Head End Height	135 cm	135 cm



Foot End Height	35 cm	35 cm
-----------------	-------	-------

SKU

MayaWing46OttNat, MayaWing50OttNat,
MayaWing46OttLGrey, MayaWing50OttLGrey

Other information

Ottoman Piston Stength (N): 800

Distance between slats: 7.3 cm

Before you start

- Please read this sheet prior to assembly to familiarise yourself with the various stages of construction. Carefully open the pack supplied and check the contents against the parts and fittings check list.
- Do not destroy any of the packaging until you are certain that you have all the necessary parts for the assembly.
- Please ensure that the packaging is disposed of in a safe environmentally friendly way.
- **Caution:** There are small components used in the construction of this unit. These loose items should be kept away from young children during assembly, to avoid danger of choking.

General Hints & Tips

- Two person assembly
- Please retain your assembly instruction and tools provided for future use. Periodically check that all bolts are still tight.

Care and Maintenance

In the unlikely event of missing or damaged parts, please contact your retailer. Please have this guide at hand quoting the part code reference numbers shown when requesting spare or replacement parts.



Warnings

- Before moving the slat frame, place the mattress on the slats. Without a mattress in place, the speed of movement is quick and may cause injury so great care is needed.
- Carefully lower the frame with the fabric hand-strap (10) ensuring the frame sides are aligned with the side panels; there should be an even gap on each side.
- If not aligned, check bed is still square and if it is, but gaps are still not even, re-align.
- Depending on the weight of the mattress, the rising speed will vary so be careful until you get used to the speed.
- Always use the hand-strap to lift or lower the frame - keep fingers well away from the moving parts.
- When fully assembled and the mattress in position, please raise & lower the ottoman 4/5 times to ensure the gas pistons are fully lubricated.
- You must ensure that the mattress is on the bed frame before operating the lift mechanism Failure to do so could result in injury.
- Keep hands clear of the mechanism when opening or closing the ottoman.
- Beware of entrapment – Never reach in through the mechanism to access the storage area.
- Always ensure that the ottoman is FULLY opened before accessing the storage area.

Important when operating



- Use caution when operating, always use the handle when lifting.
- This bed uses a pressurised mechanism.
- To be operated by adults only Please ensure that children and pets are kept away from the bed when operating the lift mechanism.
- Keep children and pets away from the storage area.
- Do not overload the internal storage base.
- Do not stand inside the internal storage area of the bed.
- Before removing the mattress secure the frame to ensure it does not open unexpectedly.
- Do not attempt to lie on the mattress when the ottoman is in the raised position.
- When lifting the ottoman remove all bedding except the fitted sheet.

Weight limits:

- **Double:** Min weight: 10 kg / Max weight: 40 kg
- **King:** Min weight: 15 kg / Max weight: 45 kg



Tools

A - Bolts (M8 x 45 mm)

24



C - Bolts (M8 x 16mm)

18



E - Allen Key for M8 bolts

1



G - Flat Washer for M8 bolt

1



B - Bolts (M8 x 25mm)

8



D - Nuts for M8 bolts

10



F - Spanner for M8 nuts

1



Parts

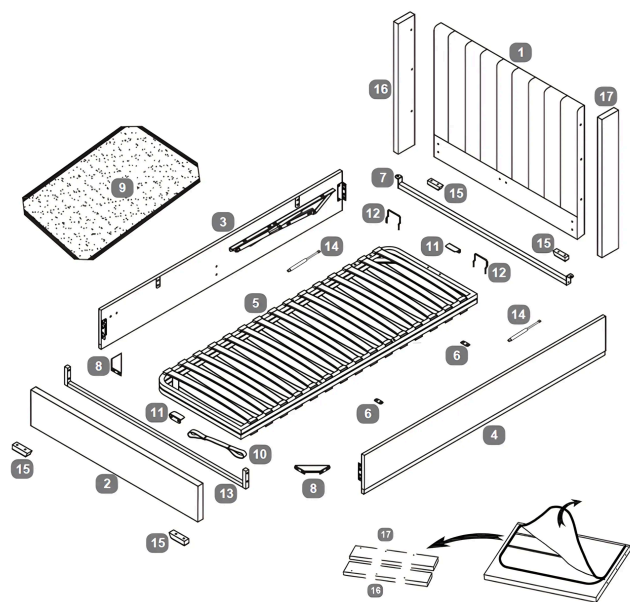

1 Headboard

1 piece(s)

2 Footboard

1 piece(s)

3 Side Rail - LH

1 piece(s)

4 Side Rail - RH

1 piece(s)

5 Metal Lift Up Slat Frame

1 piece(s)

6 Metal Connection Plates

2 piece(s)

7 Slat Frame Cross Bar

1 piece(s)

8 Angled Corner Brackets

2 piece(s)



9	Fabric Case Cover 1 piece(s)
10	Fabric Strap Handle 1 piece(s)
11	Frame Support Brackets 2 piece(s)
12	Mattress Stoppers 2 piece(s)
13	"U" Shape Cross Bar 1 piece(s)
14	Gas Lift Pistons 2 piece(s)
15	Feet 4 piece(s)
16	LH Wing 1 piece(s)
17	RH Wing 1 piece(s)

Steps (12)

1. Pre-Assembly Preparation

- Before beginning the assembly of the bed, please open the compartment located at the rear of the headboard.
- Ensure you have located the following parts necessary for assembly: Both wings, labeled as 16 and 17.
- Confirm all parts are present to proceed with the assembly smoothly.



2. Attach the Frame Support Brackets and Feet

1. Align the Frame Support Brackets (11) with the mounting holes on the Headboard (1) and the Footboard (2), and secure them using M8 Bolts (C) with the Allen Key (E).
2. Similarly, attach the Feet (15) at the bottom of both the Headboard and the Footboard using M8 Bolts (A) and tighten with the Allen Key (E).

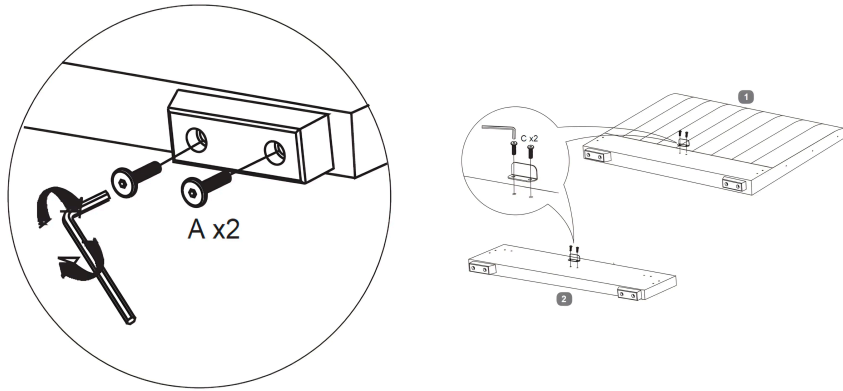

3. Attach the Side Rails

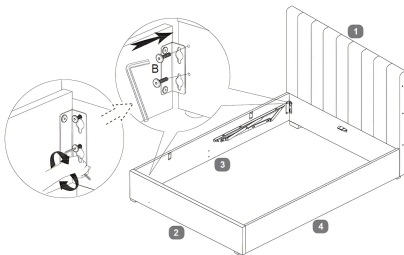

1. Secure the Side Rail LH (3) to the Headboard and Footboard using four M8 Bolts (B) and tighten with the Allen Key (E).
2. Repeat the process with the Side Rail RH (4) using another four M8 Bolts (B).
3. Ensure both side rails are firmly attached and the assembly is stable.



4. Securing the Frame's Support Structure

1. Align and secure the Angled Corner Brackets (8) to the Side Rails (3 & 4) and the Footboard (2) using M8 Bolts (C) and tighten with the Allen Key provided.
2. Attach the "U" Shape Cross Bar (13) to the Side Rails using M8 Bolts (A) and tighten with the Allen Key.
3. Ensure that the parts are aligned precisely as shown in the diagram, with the components fitting together perfectly to avoid incorrect assembly.

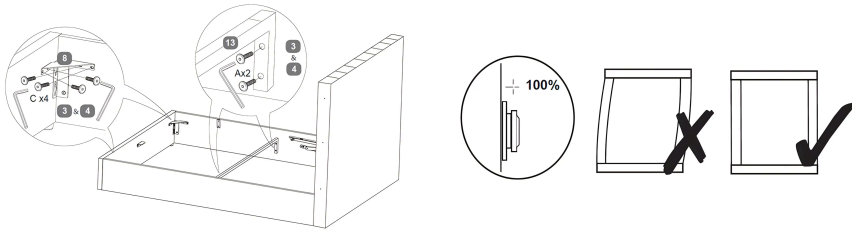

5. Attach the Fabric Base Cover

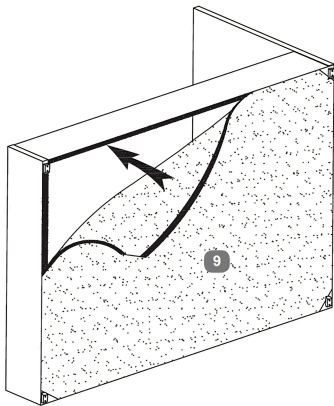

1. With assistance, carefully lift the bed and turn it on its side. Ensure both the headboard and footboard are lifted simultaneously to prevent twisting.
2. While one person holds the bed upright for safety, attach the Fabric Base Cover (9) to the bottom of the side rails, headboard, and footboard using the Velcro tape. Ensure the fabric is evenly fixed all around.

Warning: Lift the headboard and footboard together carefully. Avoid letting the bed twist.



6. Install the Slat-Frame Cross Bar

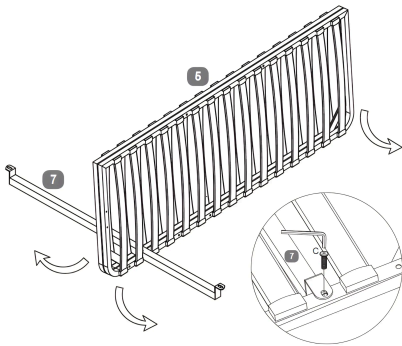

Locate the fitting position for the slat-frame cross bar (7), which is clearly labeled. At the end of the slat frame (5), thread the bar through the gap between the second and third slat. Carefully open the frame to facilitate this.

7. Install the Connection Plates

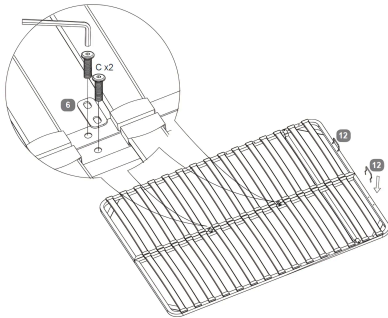

1. On the top of the slat frame, place two connection plates (6). Secure them with four bolts (C) by screwing into the threaded inserts on the top of the frame. Do not fully tighten the bolts yet.
2. Position the cross bar fixing plates on top of each side of the slat frame (5), aligning them with the round labels.
3. Ensure the plates align with the threaded holes, and loosely fix them using two bolts (C).
4. Using the Allen key (E), tighten all six bolts to 100% to ensure the structure is firmly secured.



8. Install the Gas-Lift Piston Stem

1. Slide the gas-lift piston stem (x) onto the axle (y) and attach the flange lock-nut (D).
2. Using the spanner (F), tighten the nut, ensuring not to over-tighten.

A small gap should remain to allow the stem to move freely, this is normal and necessary for proper operation, as illustrated in the sketch.

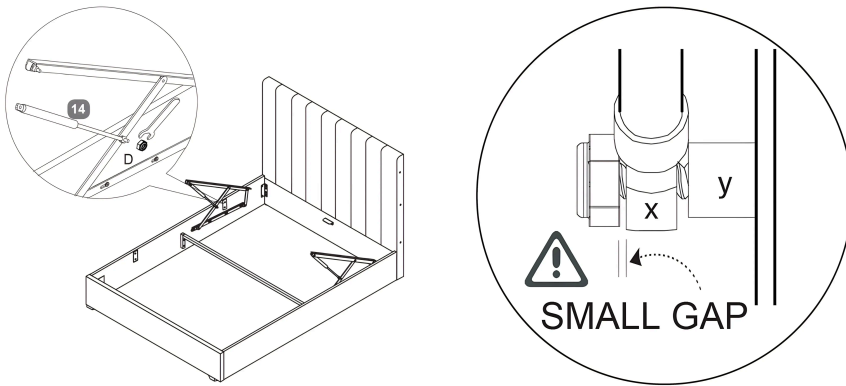

9. Secure the Slat Frame

1. Loosely fit three bolt sets on each side (A), (D), and (G). Carefully hold the frame down and align it to ensure even gaps on each side.
2. Once aligned, tighten all bolts to 100% to secure the frame firmly in place.
3. Tie the Fabric Strap Handle (10)

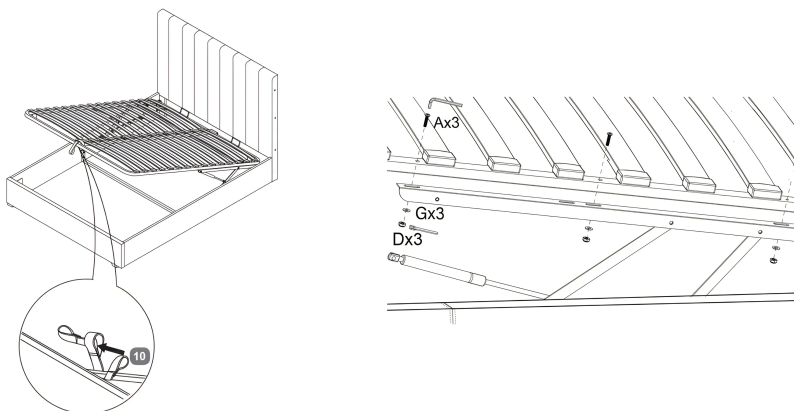

10. Install the Gas-Lift Piston Stem

1. Slide the gas-lift piston stem (x) onto the axle (y) and then secure it with the flange lock-nut (D).
2. Use the spanner (F) to tighten the nut, but be careful not to over-tighten.

Ensure a small gap remains to allow the stem to move freely; this is a normal requirement for operation, as depicted in the sketch above.

Note: Be careful what you store under the bed - the top of an item, like a suitcase or a box, must not touch the slats or they may be damaged. Maximum storage height is 25cm.

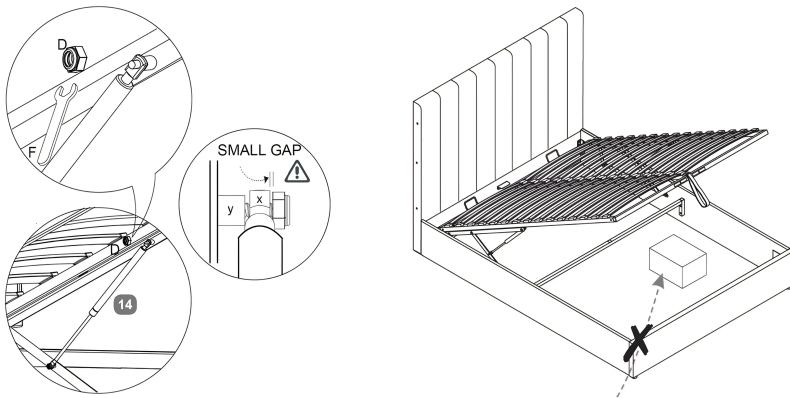

11. Attach the Headboard Wings

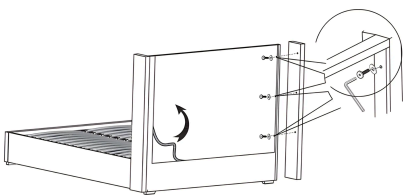

1. Open the back fabric cover of the headboard, then to fix the both wings.
2. Align the Headboard Wings (16 & 17) with the Headboard.
3. Use the provided M8 Bolts (A), Flat Washers (G) and the Allen Key (E) to secure the wings to the headboard. Ensure all bolts are tightened properly.



12. Finish and Final Check

- Close the back fabric cover of the headboard
- Verify that all slats are securely fastened and evenly spaced.
- Check for any loose connections and tighten the screws if necessary.

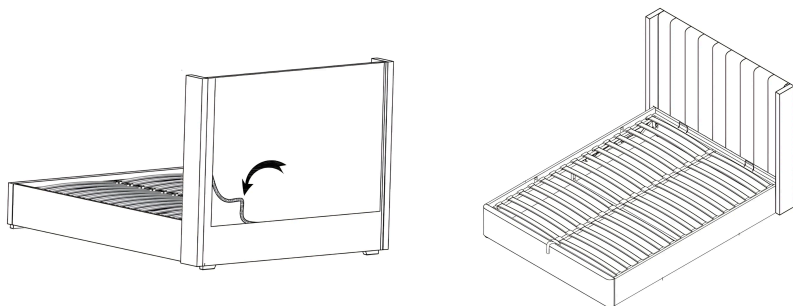

Need Help? Call 01484 500 560 or email hello@time4sleep.co.uk - please include your order number if you have one!

