

Instructions by Time4Sleep Products

Hampton Day Bed With Guest Underbed

Assembly instructions for Hampton Day Bed With Guest Underbed by Time4Sleep.



Product Information

Hampton Day Bed With Guest Underbed

Description

The versatile Hampton day bed will be a beautiful addition to your home. The under bed is mounted on easy guide castors and simply rolls out from the main bed to provide an occasional bed. Finished in a contemporary white painted finish the clean lines and shaker inspired design combine to create a stylish sophisticated look.

The Hampton is manufactured from solid rubber wood, which is valued for its dense grain, durability, minimal shrinkage, and acceptance of different finishes. Although the rubber tree is primarily grown to source rubber, the left over wood is praised as an "environmentally friendly" product, as it makes use of trees that have been cut down at the end of their latex-producing cycle. The frame comes complete with solid wooden slats for added durability.

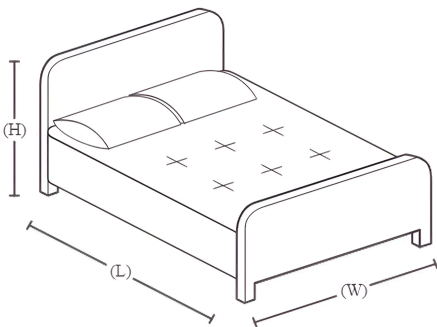

Product specifications

	Single
Width	96.5 cm
Lenght	202 cm



Head End Height	94 cm
-----------------	-------

Foot End Height	94 cm
-----------------	-------

SKU

hamptonday&trundle1

Other information

Please note that the price quoted is excluding mattresses.

The upper bed frame is designed for a standard UK mattress 90cm x 190cm (3'0 x 6'3), whilst the under bed is designed to stow under the main bed and is 75cm x 180cm 2'6 x 6'0. The underbed mattress should not exceed 17cm in height.

Important - Please read these instructions fully before starting assembly

- Check you have all the components and tools listed.
- Remove all fittings from the plastic bags and separate them into their groups.
- Keep children and animals away from the work area, small parts could choke if swallowed.
- Make sure you have enough space to lay out the parts before starting.
- Do not stand or put weight on the product, this could cause damage.
- Assemble the item as close to its final position (in the same room) as possible.
- Assemble on a soft level surface to avoid damaging the unit or your floor. Parts of the assembly will be easier with 2 people.
- **We do not recommend the use of power drills/drivers for inserting screws as this could damage the unit. Only use hand screwdrivers**
- Dispose all packaging carefully and responsibly

Glue safety - Take care when using glue, please follow the advise below

- **Skin contact** : Remove contamination by washing with soap and water. This procedure should also be followed prior to eating and drinking. Care and maintenance.
- **Eye contact** : Rinse immediately with clean water for 15 minutes and seek medical advise.
- **If swallowed** : Seek medical advise immediately.



Care and maintenance

- Only clean using a damp cloth and mild detergent, do not use bleach or abrasive cleaners.
- From time to time check that there are no loose screws on this unit.
- This product should not be discarded with household waste. Take to your local authority waste disposal center.

Tools

A - Plastic Dowell (M10 × 35mm)

6



C - JRN Nut (M6 × 13mm)

10



E - CSK C/B Screw (M4 × 32mm)

16



G - Allen Key (M4 × 60mm)

1



B - JCBC W SCREW (M7 X 32MM) for Underbed

8



D - Allen Key (M4 X 60MM) for Underbed

1



B - JCBC Bolt (M6 × 100mm)

10



D - JCBC W Screw (M7 × 32mm)

8



F - Hole Plug (15mm)

10



A - JCBC BOLT (M6 X 35MM) for Underbed

8



C - CSK C/B SCREW (M4 X 32MM) for Underbed

16



Crosshead Screwdriver

1

Parts

Headboard (L/R)

2 piece(s)



Side Rail

1 piece(s)



Front Panel for Underbed

1 piece(s)



Back Rest

1 piece(s)



Wooden Slat

12 piece(s)



Rear Panel for Underbed

1 piece(s)



Side Panel for Underbed

2 piece(s)



Wooden Slats for Underbed

12 piece(s)



Steps (9)

1. Insert Plastic Dowels

1. Locate the Backrest (2) and Side Rail (3).
2. Insert Plastic Dowels (A) into the pre-drilled holes at both ends of the backrest and side rail.
3. Ensure the dowels are fully inserted and aligned properly to connect with other components in the next steps.

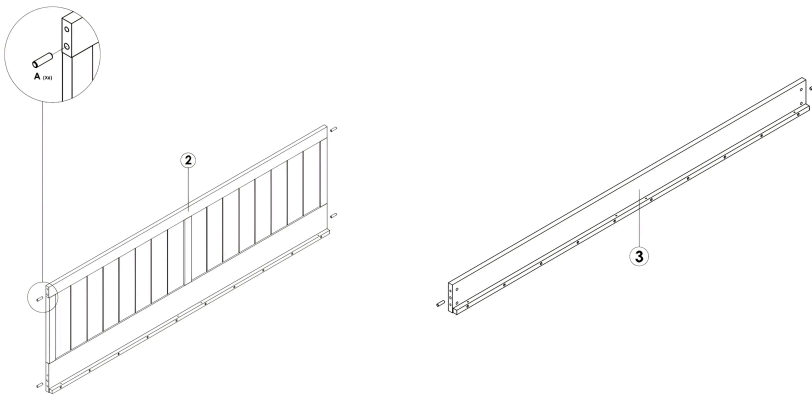

2. Attach the Headboards

1. Align the Headboards (L/R) with the Backrest (2) and Side Rail (3).
2. Insert the JCBC Bolts (B) through the pre-drilled holes on the headboards.
3. Secure each bolt using a JRN Nut (C) on the opposite side.
4. Tighten all bolts using the Allen Key (G) until secure.

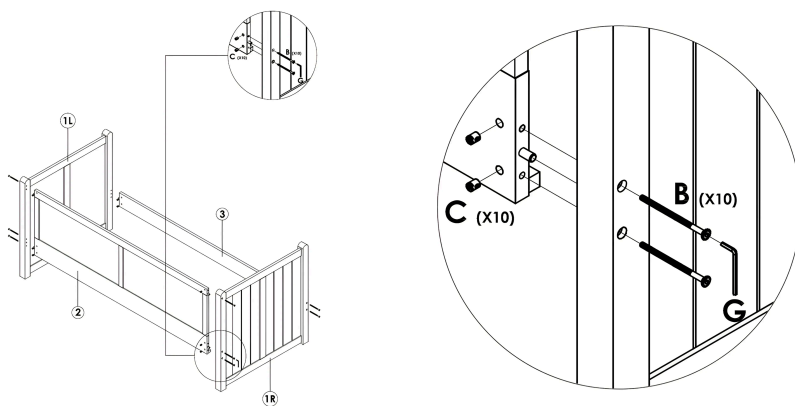

3. Secure the Center Slats

1. Position each Wooden Slat (4) onto the Backrest (2) and Side Rail (3) as shown in the diagram.
2. Align them with the pre-drilled holes on the side rails.
3. Identify the two center Wooden Slats (4) and secure these two slats using JCBC W Screws (D) and tighten with the Allen Key (G).

Note: The Side Rail (3) is flexible. First, secure one side of the two center slats (4) using JCBC W Screws (D). Then, immediately tighten the screws on the other side. If needed, gently push the center of the side rail while pulling the slat toward you to close any gaps.

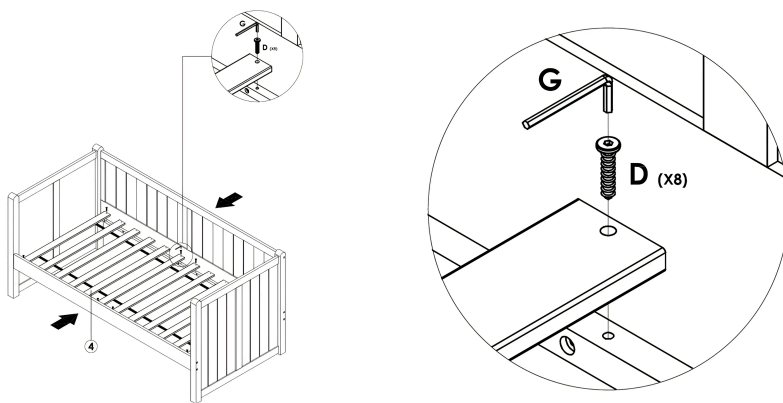

4. Attach the Remaining Slats

1. Secure the remaining slats using CSK C/B Screws (E).
2. Tighten each screw using a crosshead screwdriver to ensure the slats are firmly in place.

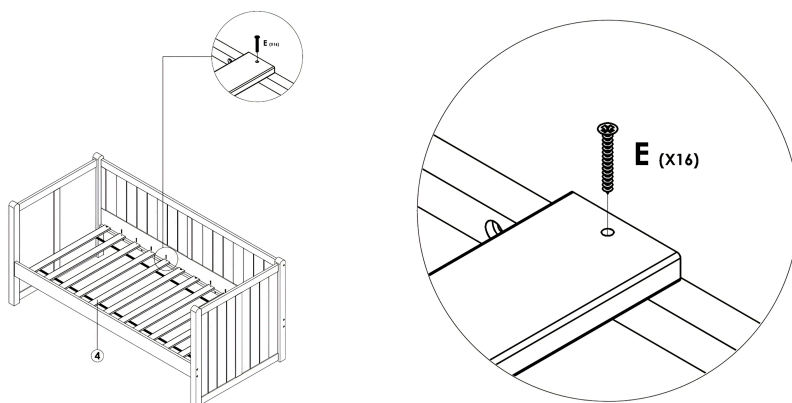

5. Installing Hole Plugs

1. Locate the exposed holes on the headboards (L/R).
2. Insert the Hole Plugs (F) into the holes to cover the screw openings.
3. Press firmly to ensure a secure fit.

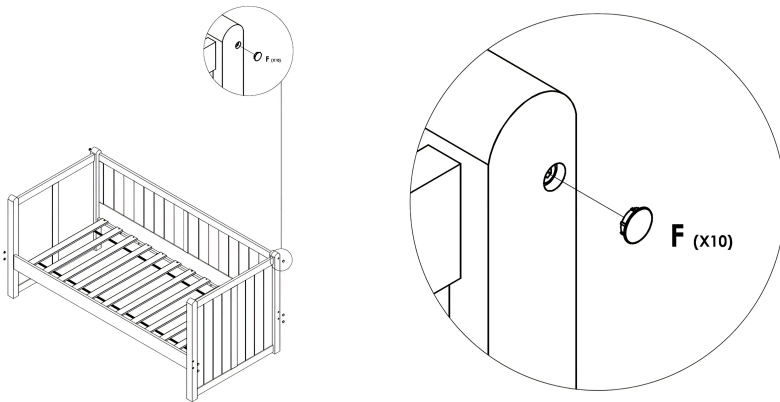

6. Assembling the Underbed Frame

1. Lay out side panels
2. Use the JCBC Bolts (M6 X 35MM) to connect the Front and Rear Panels to the Side Panels. Insert bolts into the pre-drilled holes.
3. Secure all bolts tightly with the Allen Key to ensure the frame is stable.

Check Stability: Give the frame a shake to ensure there's no wobble, adjusting if necessary.

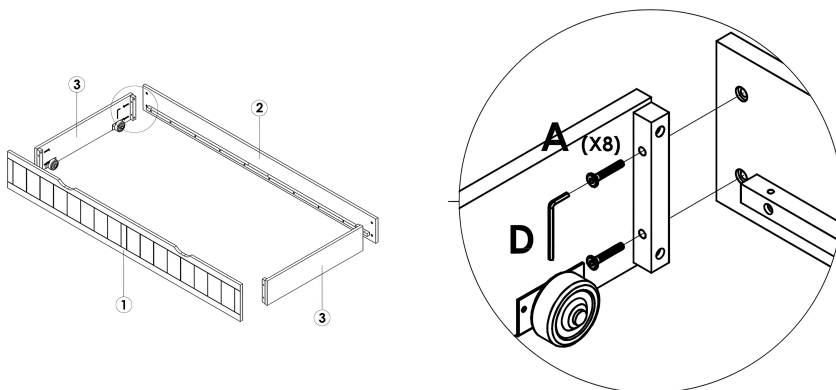

7. Position and Secure Slats

1. Position the slats
2. Locate the two central wooden slats that will be secured first.
3. Using the JCBC W Screws (B), attach the center slats at their ends. Use the Allen Key (D) to drive the screws through the pre-drilled holes on the slats into the frame.

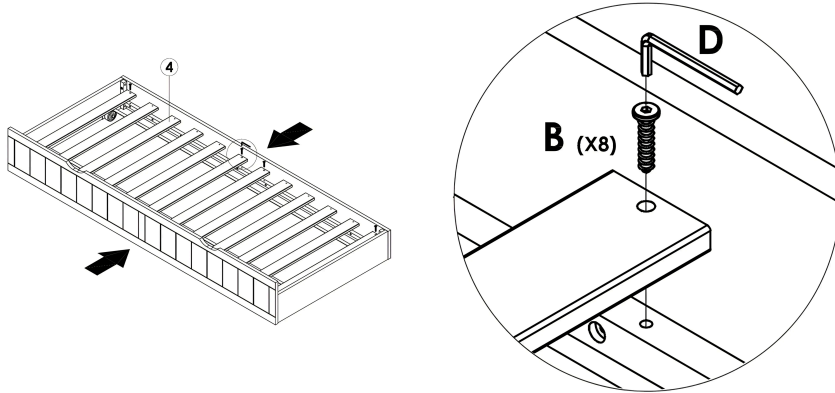

8. Attaching the Remaining Slats

1. Use the CSK C/B Screws (C) to attach the rest of the slats at both ends. Ensure each slat is aligned straight before securing.
2. Use the Crosshead Screw Driver to firmly tighten all screws, making sure each slat is securely fastened to withstand weight and use.

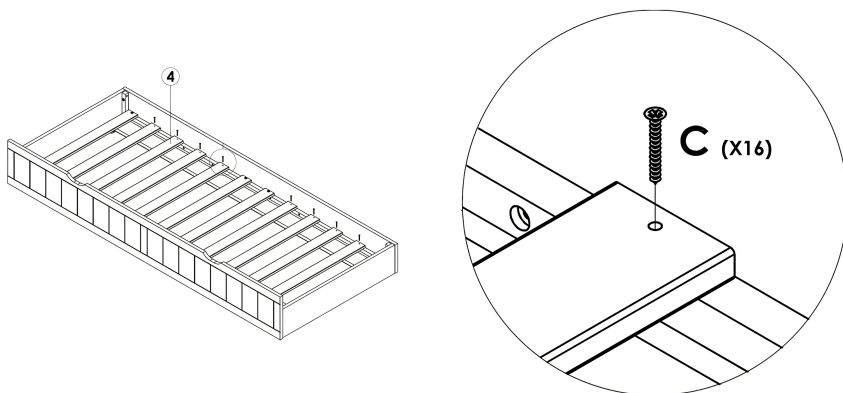

9. Final Check

- Verify that all slats are securely fastened and evenly spaced.
- Check for any loose connections and tighten the screws if necessary.

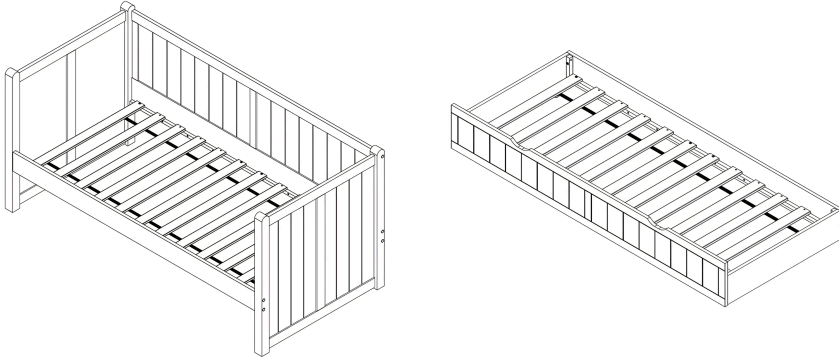

Need Help? Call 01484 500 560 or email hello@time4sleep.co.uk - please include your order number if you have one!

