

Instructions by Time4Sleep Products

Atlantis Wooden Guest Bed Including Underbed

Assembly instructions for Atlantis Wooden Guest Bed Including Underbed by Time4Sleep.



Product Information

Atlantis Wooden Guest Bed Including Underbed

Description

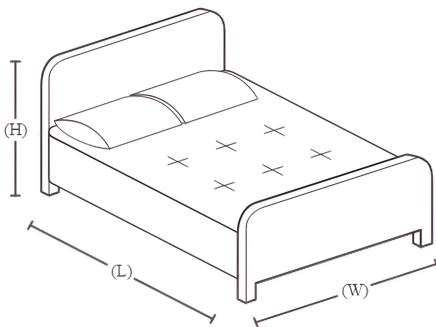

We are really excited by the launch of the new New Atlantis white Guest bed. Perfect for guests rooms and children's bedrooms we are sure that the Atlantis will become one of our best selling models. Finished in a contemporary white finish and manufactured from high quality pine the Atlantis guest bed is a highly practical and versatile bed frame. For ease of use the under bed simply rolls under the main bed on easy glide castors. When in use the underbed pulls out and raises up on spring assisted legs to the same height as the main bed frame. The guest bed can be used to make a large double bed or alternatively be used as a stand alone single bed. Constructed from high grade solid pine both the main bed and under bed come with solid wooden slats for extra durability. Mattresses are not included in the price and need to be purchased separately or why not opt for one of our money saving bundle deal options. Choose from a standard open coil quilted mattress or why not push the boat out and go for our luxury pocket sprung Luxury 1000 bundle deals. Please note if using an existing mattress the maximum height for the under bed mattress is 17cm.

Please note THE UNDERBED IS RECOMMENDED FOR OCCASIONAL USE ONLY



Product specifications

	Single
Width	99 cm
Length	205 cm
Height	102 cm
Head End Height	102 cm
Foot End Height	48 cm

SKU

AtlantisGB30White1, AtlantisGB30Oak1

Tools

A - JCBB M8 x 20mm (for bed)

8



B - CSK Screw M4 x 25mm (for bed)

26



C - M5 Allen Key (for bed)

1



A - Caster (for underbed)

4



B - CSK Screw M4 x 16mm (for underbed)

4



C - JCBC M6 x 70mm (for underbed)

4



D - M6 x 15mm Barrel Nut (for underbed)

12



E - Wood Dowel M10 x 30mm (for underbed)

12



F - JCBC M6 x 60mm (for underbed)

8



G - CSK Screw M4 x 25mm (for underbed)

26



H - M4 Allen Key (for underbed)

1



Phillips Screwdriver (not supplied)

1

Parts



Instructions by Time4Sleep Products
Atlantis Wooden Guest Bed Including Underbed

1 - Headboard Panel (for bed)

1 piece(s)

3 - Side Rail (for bed)

2 piece(s)

1 - Headboard and Footboard Panel (for underbed)

2 piece(s)



3 - Leg Panel (for underbed)

2 piece(s)



2 - Footboard Panel (for bed)

1 piece(s)

4 - Bed Slats (for bed)

1 piece(s)

2 - Side Rail (for underbed)

2 piece(s)



4 - Bed Slats (for underbed)

1 piece(s)



Steps (7)

1. Assemble Bed Frame

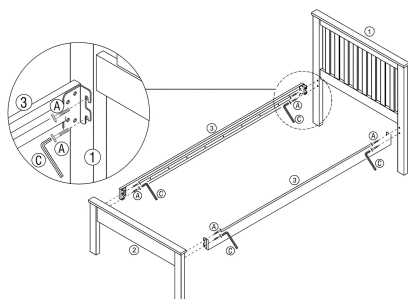

1. Position the Headboard Panel (1) and Footboard Panel (2) upright.

2. Attach the Side Rails (3) to the headboard and footboard panels.

3. Use the JCB M8 x 20mm bolts (A) to secure the side rails.

4. Tighten the bolts using the M5 Allen Key (C).

2. Attach Slats to Bed

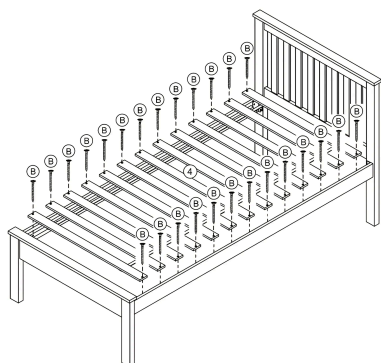

1. Place the Bed Slats (4) across the bed frame.

2. Secure each Slat using CSK Screw M4 x 25mm (B) as shown in the diagram.

3. Use a screwdriver to tighten each screw, ensuring the slats are firmly attached to the frame.



3. Attach Casters to Underbed Side Rails

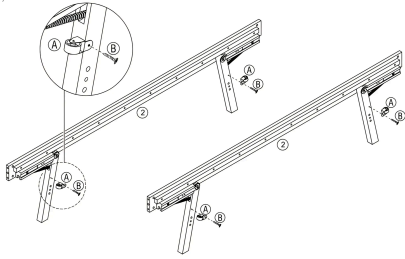

1. Position the underbed Side Rails (2) horizontally.
2. Attach the Casters (A) to each leg using CSK Screw M4 x 16mm (B) to secure them.

4. Assemble Underbed Leg Panels

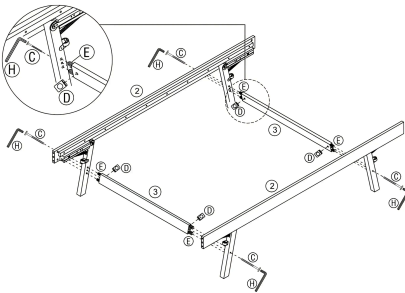

1. Insert Wood Dowel M10 x 30mm (E) into the Underbed's Leg Panels (3)
2. Align the wooden dowels (E) with the pre-drilled holes on the Side Rails (2) and insert them.
3. Insert JCBC M6 x 70mm (C) through the aligned holes and fasten with a M6 x 15mm Barrel Nut (D).
4. Use the M4 Allen Key (H) to fully tighten the bolts and ensure stability.

5. Attach Underbed's Headboard and Footboard

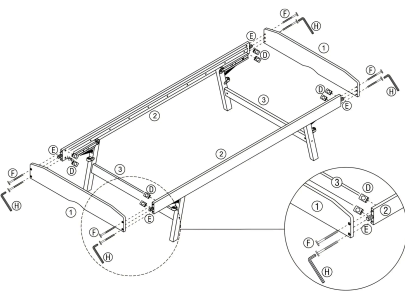

1. Insert Wood Dowels M10 x 30mm (E) into pre-drilled holes on the Side Rails (2).
2. Attach the Headboard and Footboard Panels (1) to the Side Rails (2).
3. Insert JCBC M6 x 60mm (F) through the aligned holes as shown on the diagram.
4. Fasten with a M6 x 15mm Barrel Nut (D).
5. Use the M4 Allen Key (H) to fully tighten the bolts.



6. Attach Slats to Underbed

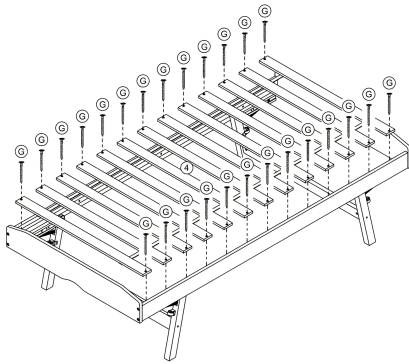

1. Place the Underbed Slats (4) across the bed frame.
2. Secure each Slat using SK Screw M4 x 25mm (G) as shown in the diagram.
3. Use a screwdriver to tighten each screw, ensuring the slats are firmly attached to the frame.

7. Final Check

- Verify that all slats are securely fastened and evenly spaced.
- Check for any loose connections and tighten the screws if necessary.

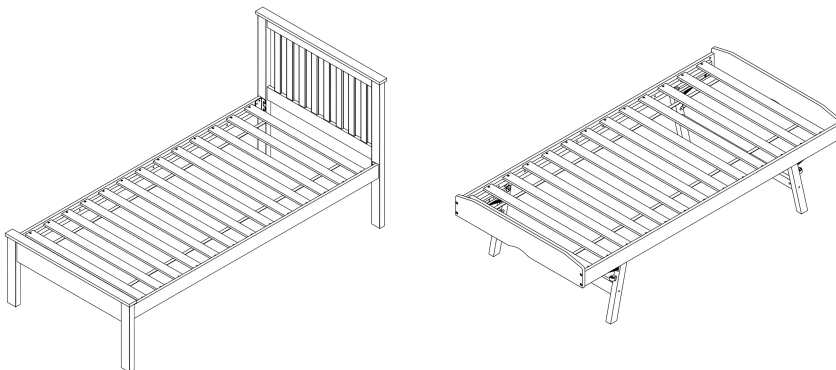

Need Help? Call 01484 500 560 or email hello@time4sleep.co.uk - please include your order number if you have one!

